



# Your Journey Awaits

1.800.959.3359 • [www.shastalake.net](http://www.shastalake.net)  
16814 Packers Bay Rd. Lakehead, CA 96051

## download our insider guides

- ✓ Pack Like a Pro Checklist
- ✓ Lake Gourmet Recipes
- ✓ Rules & Regulations
- ✓ Regional Attractions
- ✓ Boating Tips
- ✓ Special Offers & Rates

Visit [www.shastalake.net/insider](http://www.shastalake.net/insider) to download our guides.

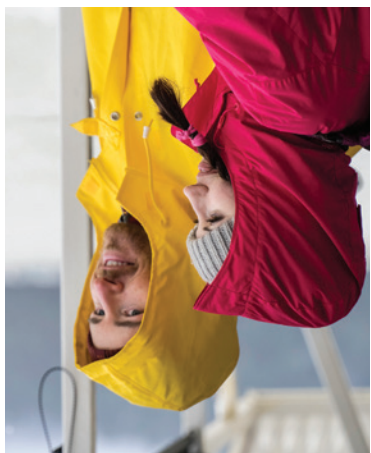

Reservations:  
Phone - 1.800.959.3359  
Fax - 1.530.238.6843  
[www.shastalake.net](http://www.shastalake.net)

SHASTA MARINA at PACKERS BAY  
16814 Packers Bay Rd.  
Lakehead, CA 96051



## the mirage I



### Sleeps 14

At 15'x56', the Mirage I is a great mid-size boat with a walk-around deck. Featuring warm light maple finishes & earth tone fabrics, this boat was designed to make you feel cozy & comfortable. For an unforgettable experience, this vessel comes equipped with all the amenities & technology you'll need.

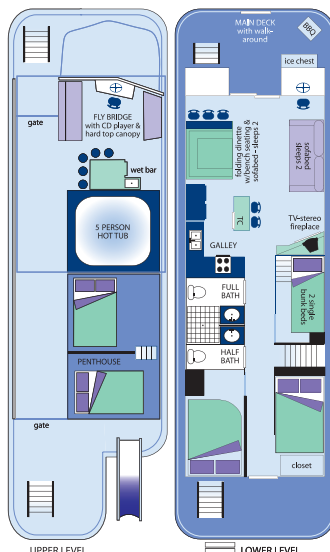

- #### Features
- 6 Double Beds
  - 2 Single Beds
  - 1.5 Baths
  - Dual Electric Refrigerators
  - Gas Fireplace
  - Hot Tub
  - Hard Top Canopy
  - Fly Bridge
  - Upstairs Wetbar
  - Water Slide

## the mirage II



### Sleeps 16

At 15'x56', The Mirage II is a full-width cabin houseboat. Luxuriously furnished, equipped with all the amenities & technology you'll need, this houseboat is perfect for families. Sit back, relax, take in the scenery & enjoy a one of a kind experience. Let the Mirage II be your home away from home.

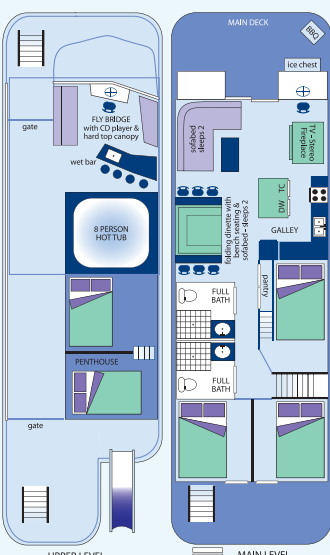

- #### Features
- 8 Double Beds
  - 2 Baths
  - Electric Refrigerator with Ice Maker
  - Gas Fireplace
  - Hot Tub
  - Hard Top Canopy
  - Fly Bridge
  - Upstairs Wetbar
  - Water Slide

## the thoroughbred



### Sleeps 16

At 15'x56', the Thoroughbred is one of our most luxurious vessels. This boat is perfect for cruising the lake with the whole family, chilling on the roof, sunbathing, or relaxing. With state-of-the-art features like the upstairs wet-bar & lounge area, the Thoroughbred is the boat everyone will love!

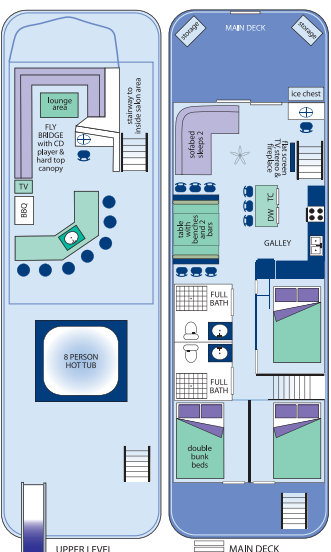

- #### Features
- 2 Queen Beds
  - 6 Double Beds
  - 2 Baths
  - Electric Refrigerator with Ice Maker
  - Dishwasher
  - Gas Fireplace
  - Hot Tub
  - Hard Top Canopy
  - Fly Bridge with Lounge
  - Upstairs Wetbar with Fridge & Ice Maker
  - Water Slide

## the constellation



### Sleeps 16

At 16'x65', the Constellation is one of our largest houseboats. Featuring a third level deck for the sunbathers & star gazers, this is the best place to be. While the kitchen & living area are arranged at the back of the boat, allowing you to view all the action on the water.

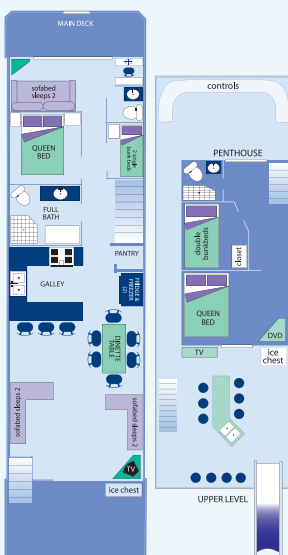

- #### Features
- 2 Queen Beds
  - 5 Double Beds
  - 2 Single Beds
  - 2.5 Baths
  - Dual Electric Refrigerators
  - Dishwasher
  - Hard Top Canopy
  - Fly Bridge
  - Upstairs Wetbar
  - Water Slide
  - Third Level Sun Deck

## the sunset



### Sleeps 20

At 16'x65', the Sunset is our newest & largest vessel with luxe features & amenities. The second floor open deck gives you plenty of space to enjoy the outdoors, while the reverse floor plan allows you to be apart of the fun on the water. You & your guests will experience a first-class vacation on this boat!

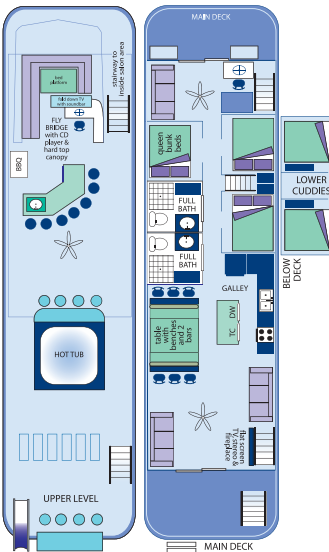

- #### Features
- 2 Queen Beds
  - 8 Double Beds
  - 2 Baths
  - Electric Refrigerator with Ice Maker
  - Dishwasher
  - Gas Fireplace
  - Hot Tub
  - Hard Top Canopy
  - Fly Bridge with Lounge
  - Upstairs Wetbar with Fridge & Ice Maker
  - Water Slide

## exquisite comfort & style

### Our Houseboats

Shasta Marina at Packers Bay takes great pride in keeping our boats exceptionally well-maintained and clean. Our boats are perfect for all types of groups—from small families to large corporate meetings or retreats. Don't miss out on a spectacular vacation! With so many on-board pleasures, there is something wonderful for everyone in your party.

The following amenities and supplies are included on each boat:

- |                    |                   |
|--------------------|-------------------|
| Satellite TV       | Dishes & Cutlery  |
| Surround Sound     | Silverware        |
| with Ipod Hookup   | Cookware          |
| DVD/CD Player      | Glassware         |
| Central Heat & Air | Wine Opener       |
| Hot Water          | Bake-ware         |
| Oven Range         | Cutting Board     |
| Toaster & Blender  | Mixing Bowls      |
| Coffee Maker       | Kitchen Utensils  |
| Microwave          | Kitchen Tools     |
| Trash Compactor    | Pots & Pans       |
| Hard Top Canopy    | Pot Holders       |
| Gas BBQ            | Cleaning Supplies |
| Inverter/Generator | Toilet Paper      |
| Deck Chairs        | Shovel            |

\* Linens, towels, food, and drinks not included.

*We love it here. You will too!*



around shasta lake

Things to do

From jet skiing along the water to exploring the shoreline, visitors to the lake can enjoy a wide range of activities.

Playtime

Shasta Marina offers additional rentals for its customers. Whether you like the rush from a speed boat, or enjoy the calm morning water on a paddle board, we have something for everyone.

- Boats
- Jet Skis
- Paddle Boards
- Kayaks

Fishing

Please check the current *California Fishing Regulations* to determine limits and any restrictions.

Hiking Trails

- Samwel Cave Nature Trail
- Greens Creek Trail
- Sugarloof Creek Trail
- Hirz Bay Trail
- Packers Bay Trail System
- Bailey Cove Trail
- Clickapudi Trail
- Dry Fork Trail

Caves & Caverns

- Samwell Cave
- Shasta Caverns

Waterfalls

- Waters Gulch
- Bear Creek Falls
- Indian Creek Falls
- Potem Falls
- Salt Creek Falls



shasta lake legend

- |                            |                             |
|----------------------------|-----------------------------|
| Nature Watching            | Marina                      |
| Camping                    | Picnicking                  |
| Boat Launch                | Lodging                     |
| Camping (boat access only) | Trailer/RV Park             |
| Hiking Trail (maintained)  | Hiking Trail (unmaintained) |
| Trail                      | Paved Road                  |
| I-5                        | Unpaved Road                |